

ww[®]
White Way

WW-Jet
3000

DENTAL ORAL IRRIGATOR ∴ ZAHN-IRRIGATOR ∴ IRYGATOR DENTYSTYCZNY ∴ ZUBNÍ SPRCHA

EN DE PL CZ



 Diagnosis S.A.
ul. Gen. W. Andersa 38A,
15-113 Białystok, POLAND
www.diagnosis.pl

REF 4001



Rev. 2017.04.06

USER MANUAL

Dental Oral Irrigator
WW-Jet 3000

WW-Jet 3000

ENGLISH

Thank you for buying WhiteWay product.

The WW-Jet 3000 Irrigator effectively and quickly removes food debris and bacteria from hard to reach areas in the interdental spaces and under gum line –where a traditional toothbrush or dental floss cannot reach. Our irrigator is a non-invasive way to remove surface stains and plaque, stimatenously offering gum care. It is an irreplaceable device for complete dental care. Highly recommended for people with tight spaces between teeth, and those having braces, bridges, crowns and implants.

Please read these instructions before using.

DANGERS

- Do not immerse totally in water or in any liquids.
- Do not use the product while bathing.
- Do not place or store the product where it can fall into tub or sink.
- Do not reach for the product that has fallen into water. Unplug immediately.
- Do not disassemble, repair or remodel the main unit. Warranty is void under unauthorized attempt to open the main unit.

WARNINGS

- This appliance can be used by children aged from 8 years. Toddlers or people who are not able to operate should be supervised by adults.
- Use this product only for its intended use as described in this manual.
- Do not use attachments not recommended by the manufacturer.
- Do not operate any appliance with a damaged cord or plug. Contact authorized service facility for examination.
- Do not plug or unplug the power cord into the electrical outlet that has a voltage different than that specified by the producer (110-240V).
- Do not use near heated surfaces or outdoors.
- Do not fill the tank with water warmer than 40°C.
- Please do not use without the nozzle
- Keep away from small children. It contains the small parts enough to be swallowed and can be become lodged in the throat.
- Do not press the nozzle against your teeth or gums.

Keep this user manual!

CONFIGURATION

- a Nozzle release button
- b ON/OFF button
- c Mode button
- d Mode indicator
- e Charging base
- f Charging base cover
- g Nozzle
- h Identification ring
- i Nozzle suction tube
- j Filter
- k Water tank
- l Water tank cap

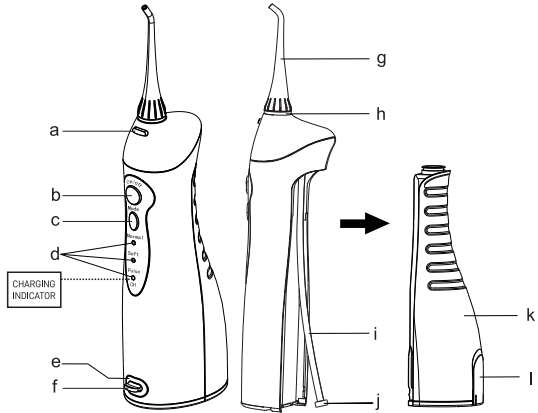

NOTE!

There may be some liquid remaining inside the main appliance, this is the remaining distilled water that was used for the performance test.

HOW TO USE

Charging the device (Fig. 1)

1. Take the charger base cover down and insert the appliance plug securely into the appliance socket (make sure no liquid remaining inside the socket before insert the appliance plug).
2. Insert the charging adaptor securely into power outlet.
3. The "CH" indicator blinks when the device is charging, and it will be steadily on after the device is full charged.
4. Recover the cover onto charger base again after charging finished.

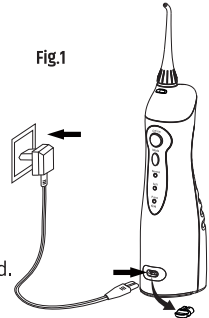

NOTE!

If the "CH" indicator is blinking during or after an irrigating, that means the battery need to be recharged. An full recharging will take about 8 hours.

USE THE ORAL IRRIGATOR

1. Attach nozzle (irrigator tip onto the unit). (Fig. 2)
2. Open the water tank cap to fill the tank with water which temperature does not exceed 40°C, then close the cap. (Fig. 3)
3. Or, Slide the water tank down off the unit, fill the tank with water which temperature does not exceed 40°C, then attach the tank onto the unit. (Fig. 4)
4. Press "Mode" button to select the mode you desired. During irrigating, you can change the working mode. (Fig. 5)
 - **Normal:** for normal cleaning.
 - **Soft:** for gentle cleaning of sensitive gums.
 - **Pulse:** for cleaning and massaging the gums.

Hold the unit in an upright position with nozzle tip point toward your teeth.
6. Keep your mouth opened slightly so that the water can flow out.

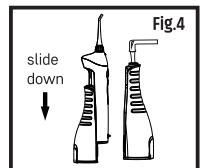
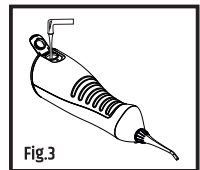
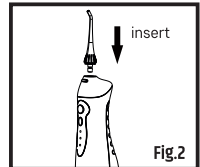

7. Press "ON/OFF" button to start irrigating. (Fig. 6)
 - Directing the water jet flow at a 90-degree angle to the teeth and gums.
 - Directing the water jet slowly along the teeth, providing a gentle massage. From time to time stop the irrigator at interdental spaces to remove food debris.
 - Keep Cleaning your upper and lower teeth from both sides between the teeth.
 - In the same way clean around any braces, crowns, or bridgework.
8. Press "ON/OFF" button and then press the nozzle release button to replace other nozzle when you need. (Fig.7)
9. Once irrigating complete, press "ON/OFF" button again to turn off the device.

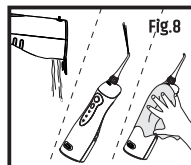
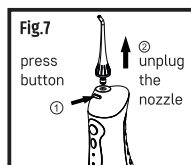
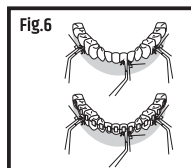
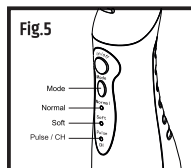

AFTER USING THE APPLIANCE (Fig.8)

1. Open the water tank cap and dispose of the water in the tank.
2. Press "ON/OFF" button to turn on the unit, and drain the water inside the appliance.
3. Press "ON/OFF" button again to turn off the unit, and close the water tank cap.
4. Wipe the device with dry cloth

Note!

To prevent bacteria propagating, make sure there is no remaining water inside the unit. If you're not going to use this appliance for long time, be sure wipe and dry the appliance.

MAINTENANCE

Use only water or neutral cleaning agent to clean the device. Never use caustic or abrasive agents. Do not wash using hot water of over 40°C. Keep the device away from high temperature area; avoid direct sunlight and sudden shocks.

IRRIGATOR

- Remove the dirt by wiping using a cloth with liquid and wipe off using a dry cloth.
- Do not submerge the main unit in water to clean.

WATER TANK CAP

- Wipe off any grime and dirt with a cloth.

NOZZLE

- Wash with water and wipe with soft cloth.
- Replace the nozzle every 6 months.

WATER SUCTION TUBE

- Wash with water and wipe with soft cloth.
- Do not bend, pull or twist the water suction tube.

TANK

- Wash with water and wipe with soft cloth.
- Dry the tank when not using for a long period.

TROUBLESHOOTING

Problem	Possible Cause	Solution
It does not work	Battery is out of power	Charge the unit for at least 8 hours
It only works for a few minutes even after charging	The battery has reached the end of its life cycle.	Charge the unit for at least 8 hours
		Contact service center for support.
Water pressure is very low	There is dirt stuck in the nozzle	Replace the nozzle
	The nozzle is deformed	Replace the nozzle
	There is dirt stuck in the filter	Clean the filter
Water does not come out	Water tank is incorrectly positioned	Use the irrigator in a vertical state

WASTE DISPOSAL

Used up product shall be supplied to a waste collection point. Contains ingredients hazardous to the environment. Correct disposal of the device helps secure precious resources and avoid negative impact on health and the environment, which can be endangered by incorrect waste handling. If you have any doubts where to dispose of your device, contact Diagnosis S.A. or your local distributor.



SPECIFICATION

Reservoir capacity	150ml
Total emptying of reservoir	in 40~60 sec. Normal mode
Dimensions	56(L) x 74(W) x 273(H) mm
Weight	450 g
Water pressure	40~90 PSI
Waterproof	Irrigator IPX7, adapter - IPX4
Power (irrigator)	Battery Li-ion 1500 mAh battery provided, charges full in 8 hours
Input voltage (adaptor)	110-240 V, AC 50/60 Hz
Operating Environment	18 - 25°C; 10-95% RH
Storage Environment	-20 - 60°C; 10-95% RH
Warranty	2 years
Included Inside	irrigator, 2 nozzles, adaptor, user manual

USED SYMBOLS:



Manufacturer



Read the operating instructions before use



Catalogue Number

Rev.

Date of the last revision

IPX

IP Code